

WORK REPORT

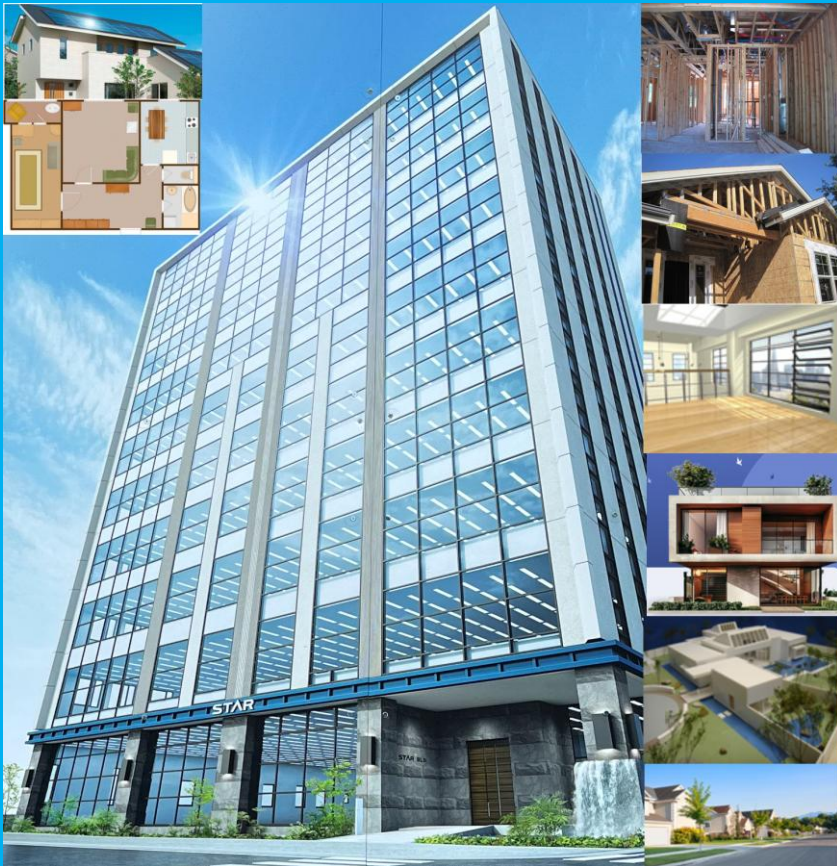

Constructionplace.com offers this virtual App for keeping track of all daily activities such as visitors of importance, Accidents or Damage, Work behind schedule, Extras, Overtime, Weather, Building Department Sign offs, and Schedule. The app features a start and stop fetching button that displays actual time spent on the project. Reports can be saved by date and emailed. Its fast, easy and paperless. Reports can be saved by date and emailed. Any registered user can use the app with our affordable **30-30 Project Management Plan**



Ponta Inc
Construction Manager

Home | Logout | Terms | My Portfolio | Join Forum

Helping you build
Empowering project owners and service, material and equipment providers to achieve their ultimate goals while helping the Construction Industry go Green with cutting edge technology from project concept through completion.

Email ID garyw@constructionplace.com	Primary Contact Number (808) 797-7025	Secondary Contact Number (808) 797-7925
Contact Person Name Gary Westermoff	Contact Person Title CEO	
Address 1777 Ala Moana Blvd #E35	Zip Code 96815	
City Honolulu	State Hawaii	Country United States
Trade/Speciality Construction Management Online	Website http://Constructionplace.com	Resume Gary_Westermoff.pdf

[Send Request](#)

We suggest using Viewable Service Providers. If they are not listed you can invite them to make their Profiles viewable.

Login

Sign In to your account

Remember me?

[Login](#) [Forgot your password?](#)

[Facebook](#) [Google](#)

Sign up

Don't have an account? Sign up today, Its FREE!

[Register Now!](#)

PROJECT OWNER DASHBOARD

Switching Roles

Alerts - To update key expiration dates
Notifications - From non-registered Referral Program users
Inquiries - From posted Projects and Profiles
Messages - From Project messaging
Logout, My Account, Change Password, Order History, Account Sharing

constructionplace.com®

Dashboard

Projects

Service Providers

Services and Help

Blog

FAQ



Project Owner

Service Provider

POST PROJECTS FOR GETTING ESTIMATES AND BIDS

Add/Edit My Profile

Add Projects Instantly

Send RFPs

RFP's Sent and Bids Received

Non RFP Bids Received

All Projects Inquiries Received

PROJECT MANAGEMENT

Add Project Location

Add/Manage Projects

Guarantees and Warrantees

INVITE USERS

Become an Affiliate to Invite with Unique URL

Good Afternoon

W Gary Westernoff

Project Owner

Welcome project owner you can post projects, update profile, manage projects, invite projects owners and much more...

Project

Post Project for Bids/Estimates/Inquiries

- Project Owner Profile
- Add New Project
- Send RFPs
- RFPs Sent and Bids Received
- Non RFP Bids Received
- All Projects Inquiries Received **3**

Tools

Project Management Tools

- Add Project Location
- Manage Projects
- Track Guarantees & Warrantees

Your profile timeline

Project Owner Profile

My Account Profile

Create Project

Completed



Select View All

2

Recent Projects

View All

Find information about your latest projects.

Project	Status	Action
Help Building Go Green	Pending	
For Taemiwest@gmail.com	Pending	
Joes Project (EXAMPLE PROJECT) ADD YOUR PROJECT TODAY 2021.001	Scheduled Date(s) Expired	
Internatinal Project (EXAMPLE PROJECT) ADD YOUR PROJECT TODAY	Scheduled Date(s) Expired	
Remodel Bathroom	Pending	



About Us

About Us
Contact Us

Professional Help

Get Free Quote
Courses and Training

Self Help

Publications
Worksheets
Glossary
Planning Projects

Work With Us

Referral Program
Affiliate Program

Terms & Policy

Terms of Use
Privacy Policy



Tutorial

constructionplace.com®

© 1999-2024 Ponta, Inc. All Rights Reserved

Developed by Future Expert

ADD DAILY WORK ACTIVITIES

ALL PROJECTS DASHBOARD

Add 30 Calendar Days \$30.00 US Dollars

Add Project Location

1-12 Reisenmachi, Hakata Ward, Fukuoka, JP-812-0039 [Non-Owned Property]

Project/Job #	Project Name	Project Scope	Project Status	Completed On	Viewable	Action
	Internatinal Project (EXAMPLE PROJECT) ADD YOUR PROJECT TODAY	New Construction	Scheduled Date(s) Expired		No	RFP Bid 🕒 📄 📅 PM 📧

Recall by date saved

Select **Work Report**

3

WORK REPORT DASHBOARD

Report Date: 02/27/2025 Saved Reports: Please select ▼

Resource	Total Staff	Trade/Specialty	Time Arrived	Time Departed	Work Performed	Email/Edit Resource
The Waterfront Group	<input type="text"/>	Small Commercial and Retail	Fetch Time: <input type="text"/>	Fetch Time: <input type="text"/>	<input type="text"/>	<input type="button" value="✉"/>
Ponta Inc (CM)	<input type="text"/>	Construction Management Online	Fetch Time: <input type="text"/>	Fetch Time: <input type="text"/>	<input type="text"/>	<input type="button" value="✉"/>
Waterfront Waterfront	<input type="text"/>	Construction Photography	Fetch Time: <input type="text"/>	Fetch Time: <input type="text"/>	<input type="text"/>	<input type="button" value="✉"/>
Waterfront Waterfront	<input type="text"/>	Design Build Construction and Development	Fetch Time: <input type="text"/>	Fetch Time: <input type="text"/>	<input type="text"/>	<input type="button" value="✉"/>

Enter number or workers, arrival and departure times and work performed

Names will autofill from Project Directory with links to Service Provider Profiles or Add Service Providers or Resources above

Report Includes:
 Visitors of importance
 Accidents, Damage, etc.
 Work behind Schedule
 Extras, Back charges, etc.
 Overtime authorized
 Building department signoffs
 Completion

Links to other 30-30 Plan Tools and Email

Work Report: 2/29/2025

Report Date: 02/11/2025 Saved Reports: 02/11/2025

File #1 (Image or Document)

 File Description:

File #2 (Image or Document)

 File Description:

File #3 (Image or Document)

 File Description:

File #4 (Image or Document)

 File Description:

File #5 (Image or Document)

 File Description:

Upload Documents or Images with Descriptions

Save to keep Report